



LIAN LI

Feel the difference

LANCOOL 205

Installation Guide / 安裝說明書
Guide d'installation / Montageanleitung
Guía de instalación / インストレーションガイド

- * Case components * Composants du boîtier * Guía de instalación
 * 機殻部品紹介 * Gehäusekomponenten * ケース各部紹介

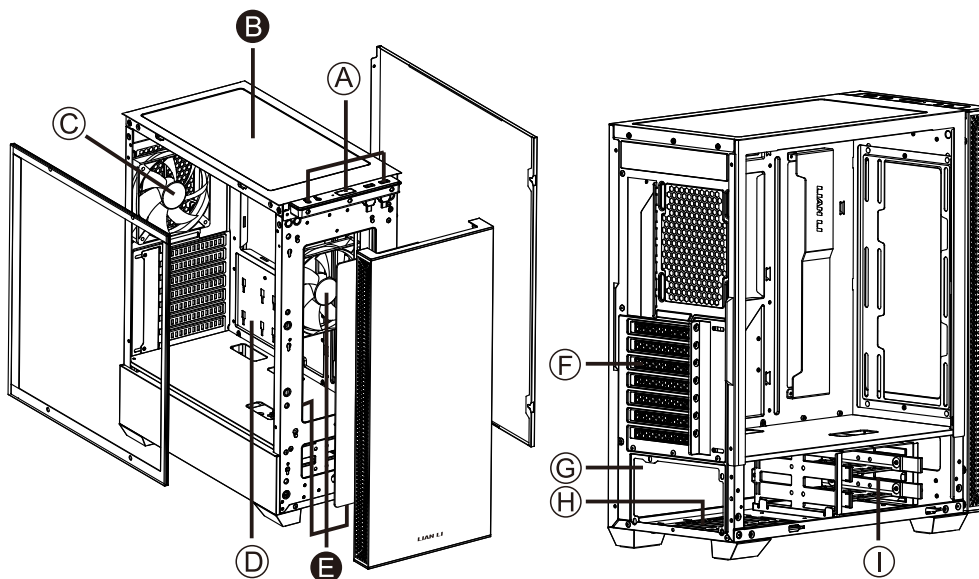

(A) IO Panel : Power Button, USB 3.0 x 2, Audio, Microphone, Power LED.

* (B) Support - 120 mm fans x 2 or 140 mm fans x 2, or 240 mm AIO radiator or 280 mm AIO radiator
 Removable fan tray & air filter

(C) 120 mm PWM fan, (Support 120 mm AIO)

(D) HDD rack (for 2.5 " HDD x 2)

120 mm PWM fan

* (E) Support - 120 mm fans x 2 or 140 mm fans x 2, or 240 mm AIO radiator or 280 mm AIO radiator
 Removable fan tray & air filter

(F) PCI slots with ventilation

(G) PSU tray

(H) Removable air filter

(I) Removable HDD tray x 2 (for 3.5 " HDD x 2 or 2.5" HDD x 2)

* (B) & (E) can be swapped after the fans and AIO radiator have been installed.

*** Hardware list**
* 零件盒部品一覧表

*** Liste des pièces**
* Hardwareliste

*** Lista de materiales**
* 付属品一覧



Screws for motherboard and 2.5" HDD mount

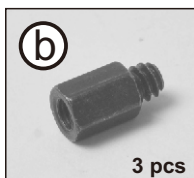

Stand-off bolt (Spare parts) for motherboard mount

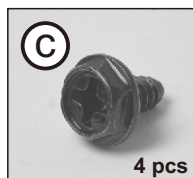

Screws for PSU mounting

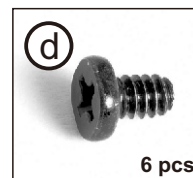

Screws for bracket and 3.5" HDD mount

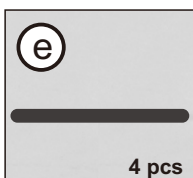

Velcro for cable management



bracket for strengthen the structure

※ Exceeded quantity are spare parts.
※ 多餘的零件數量是備品。
※ Les pièces supplémentaires sont des pièces de rechange.
※ Zusätzliche Teile können als Ersatzteile verwendet werden.
※ Exceeded quantity are spare parts.
※ ネジには予備が含まれてれています。

*** I/O port installation**
* USB 3.0 / HD Audio 接線定義
* Installation du port E/S
* I/O-Port installieren
* Instalación de los puertos de E/S
* I/O ポートに関して

USB 3.0 Supports motherboard USB 3.0 20 Pin header

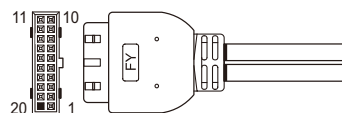

HD AUDIO

Blue	10	9	Green
Black purple	8	7	Key
Yellow	6	5	Orange
Gray	4	3	N.C.
Red	2	1	GND+H.S. TUBE

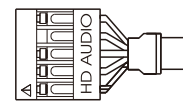

- * Remove front panel
- * 卸下前面板
- * Retirer le panneau avant
- * Frontplatte entfernen
- * Retire el panel delantero
- * 前面パネルを取り外す



- * Remove the side panel
- * 側板拆卸
- * Retirez le panneau latéral
- * Seitenwand abnehmen
- * Extracción del panel lateral
- * サイドパネルの取り外し

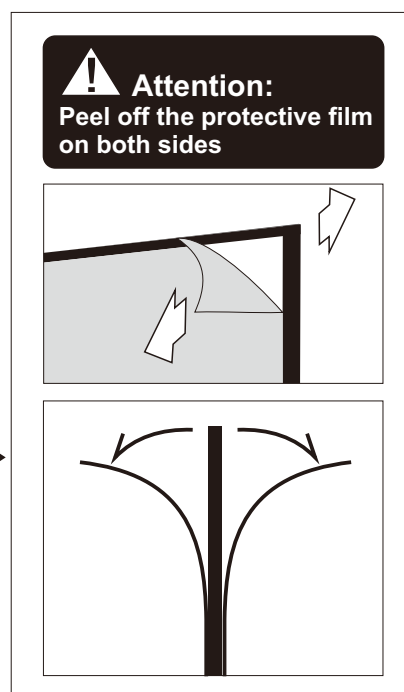
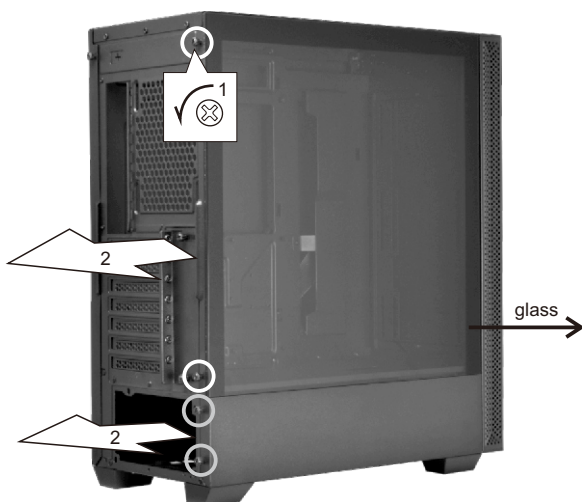

- * Motherboard installation
- * 主機板安裝
- * Installation de la carte mère
- * Motherboard installieren
- * Instalación de la placa base
- * マザーボードの取り付け

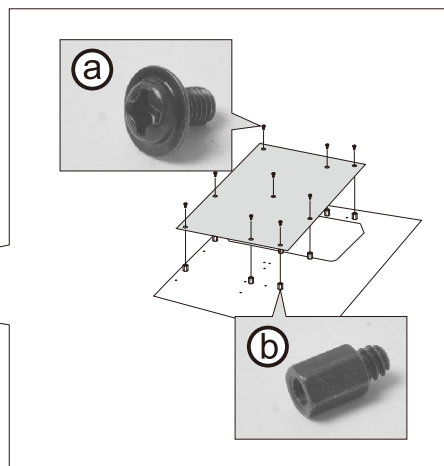
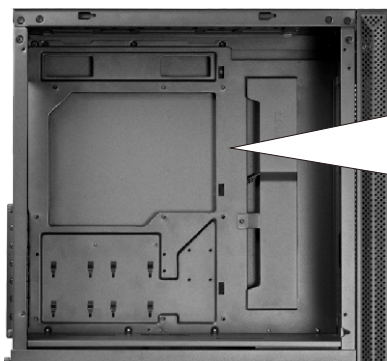

- * Remove air filters
- * 空氣濾網拆卸
- * Retirez les filtres à air
- * Entfernen Sie Luftfilter
- * Retire los filtros de aire
- * エアフィルターの取り外し

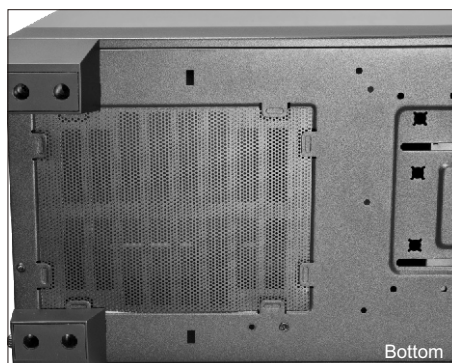

- * PSU installation
- * 電源供應器安裝
- * Installation du plateau du bloc d'alimentation

- * PSU-Einsatz installieren
- * Instalación de la fuente de alimentación
- * 電源ユニットの取り付け

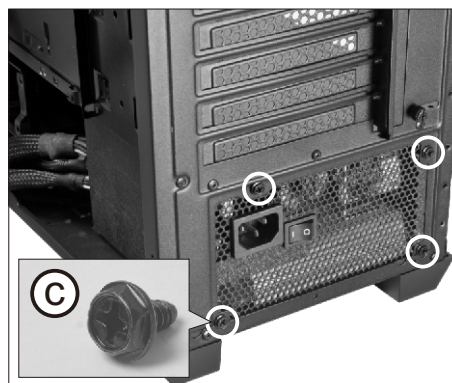
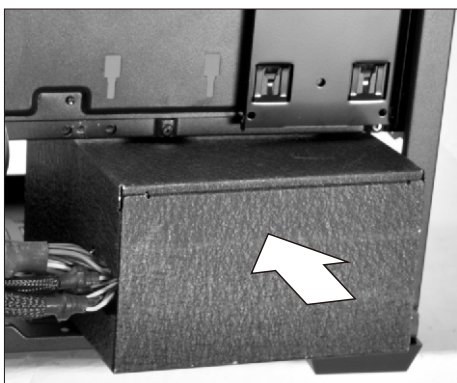

- * Bracket installation
- * 補強架安裝
- * Installation du support

- * Montage der Halterung
- * Instalación de soporte
- * ブラケット取り付け

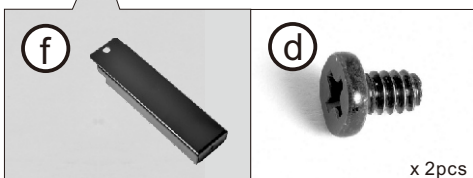
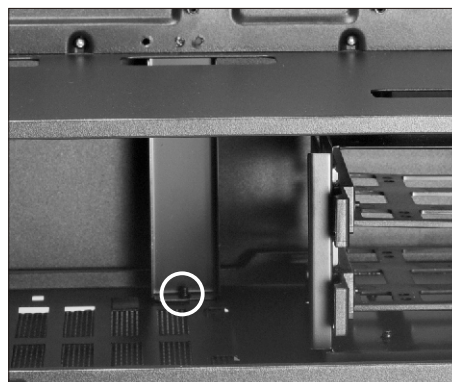
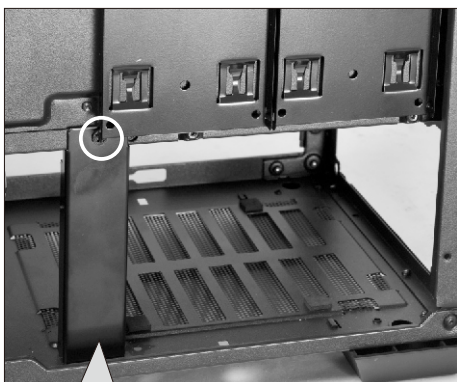

- * 2.5"/3.5" HDD installation
- * 2.5/3.5吋硬碟安裝
- * Installation d'un DD 2.5"/3.5"
- * 2.5/3.5-Zoll-Festplatte installieren

- * Instalación de unidad de disco duro de 2.5"/3.5"
- * 2.5"/3.5" ハードディスクの取り付け

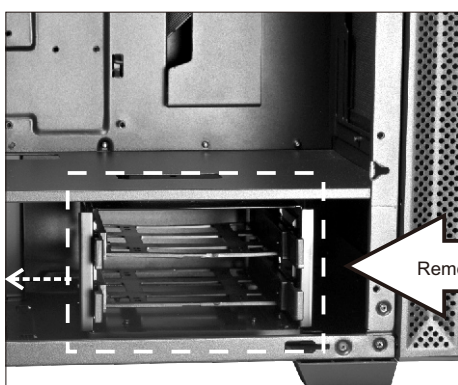

Removable

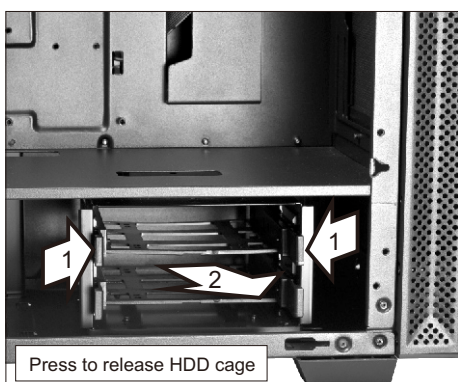
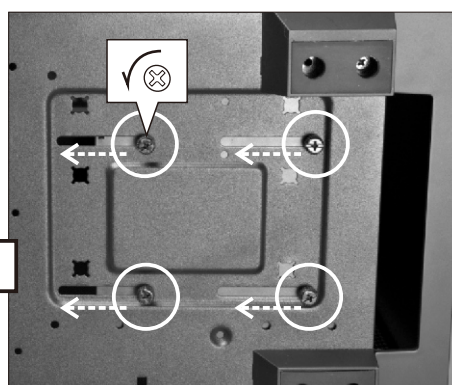

Press to release HDD cage

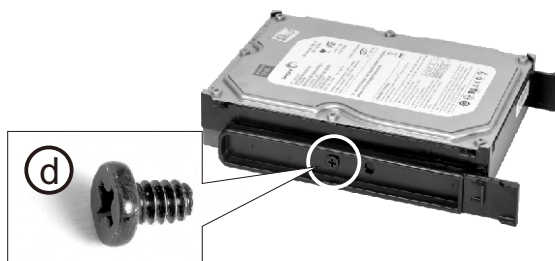
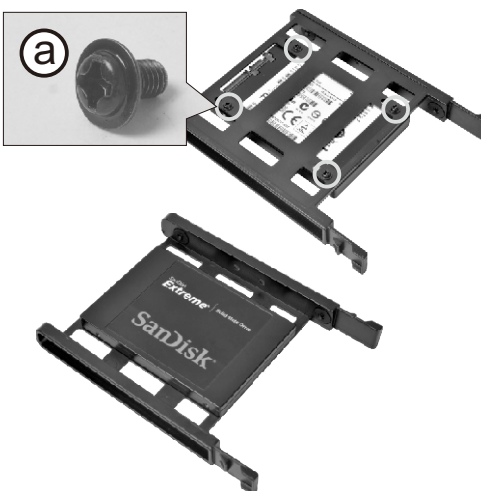

- * 2.5" HDD installation
- * 2.5吋硬碟安裝
- * Installation d'un DD2.5"
- * 2.5-Zoll-Festplatte installieren
- * Instalación de unidad de disco duro de 2.5"
- * 2.5"ハードディスクの取り付け

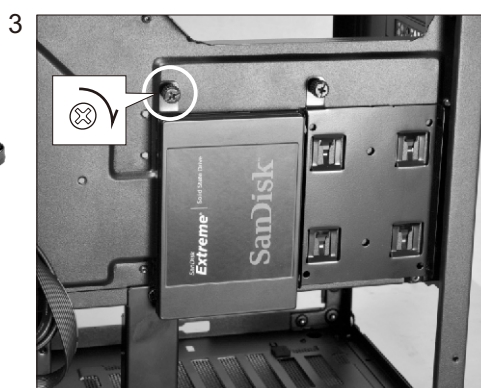
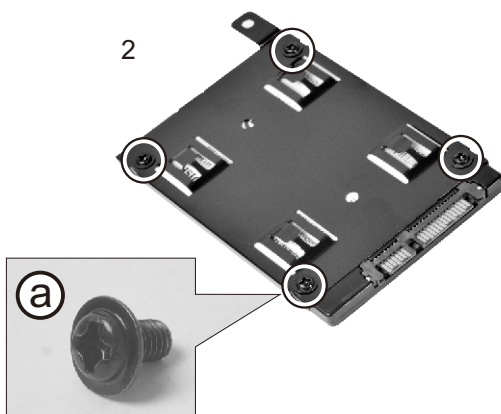
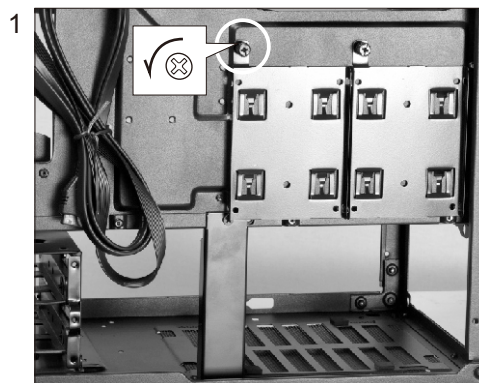

- * Cable management
- * 線材管理
- * Gestion des câbles
- * Kabelmanagement
- * Mantenimiento de cable
- * ケーブル管理

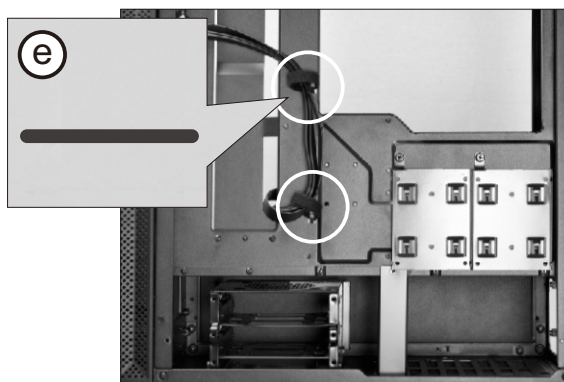

- * Remove fan tray
- * 拆卸風扇架
- * Retirer le plateau du ventilateur
- * Lüfterwanne entfernen
- * Retire la bandeja de ventiladores
- * ファントレイを取り外す

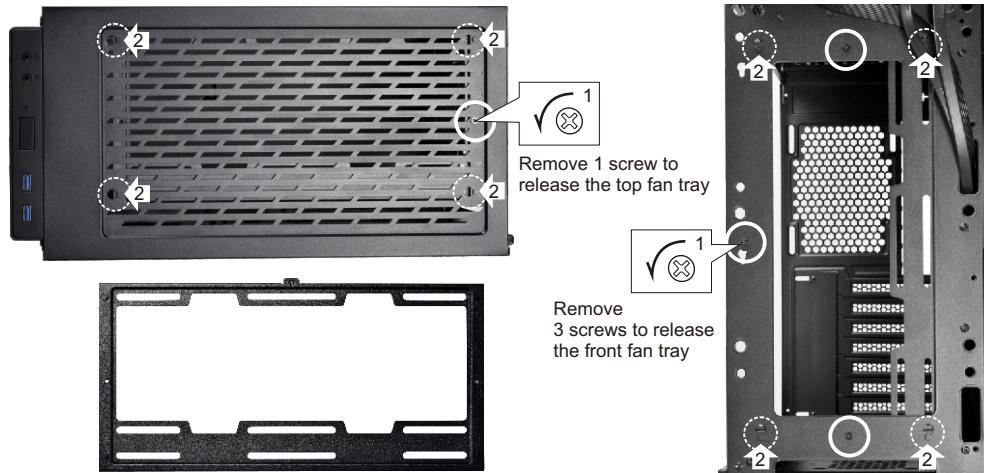

- * Radiator & cooling support
- * 散熱器 & 水冷排支援
- * Assistance radiateur et refroidissement
- * Kühler- und Kühlungsunterstützung
- * Radiador y soporte de refrigeración.
- * ラジエーター&冷却サポート

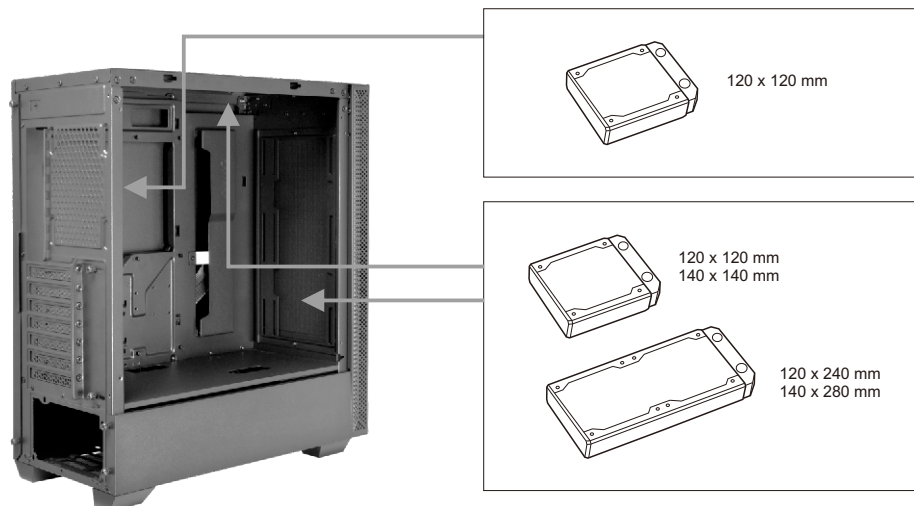



<http://www.lian-li.com>

G50.OE7430.10L